

# PRODUCT DATASHEET

## PANEL VAL 600 36 W 3000 K WT

PANEL VALUE 600 | Square recessed panel luminaires, 600 x 600 mm

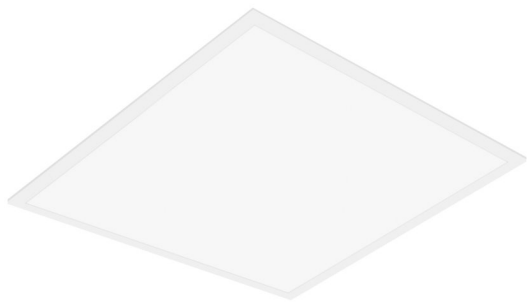

---

### AREAS OF APPLICATION

- Direct replacement for luminaires with fluorescent lamps
- Offices, conference rooms
- Reception areas, foyers, corridors, elevators
- Suitable for recessed ceiling systems with grid size of 600 x 600 mm

---

### PRODUCT BENEFITS

- Value for money luminaire
- Low flicker light thanks to special electronic control gear
- Energy savings thanks to system efficacy of up to 100 lm/W
- External driver for extended flexibility and easy installation
- Versions with DALI ECG available

---

### PRODUCT FEATURES

- Lifetime (L70/B50): up to 50,000 h (at 25 °C)
- Extruded aluminum frame
- Polystyrene diffuser



---

**TECHNICAL DATA****Electrical data**

Nominal wattage	36.00 W
Operating mode	External LED driver
Nominal voltage	220...240 V
Mains frequency	50/60 Hz
Power factor $\lambda$	> 0.90
Max. no. of lum. on circuit break. B16 A	19
Max. no. of lum. on circuit break. C10 A	19
Max. no. of lum. on circuit break. C16 A	30
Inrush current	10.4 A
Total harmonic distortion	< 15 %
Inrush current time $T_{h50}$	200 $\mu$ s

**Luminaire control gear data**

Low flicker	Yes
ECG - Output ripple current	$\leq$ 5 %

**Photometrical data**

Color temperature	3000 K
Color rendering index Ra	>80
Light color (designation)	Warm White
Luminous flux	3600 lm
Luminous efficacy	100 lm/W
Standard deviation of color matching	5 sdc <sub>m</sub>

**Light technical data**

Beam angle	120 °
------------	-------

## Dimensions &amp; weight

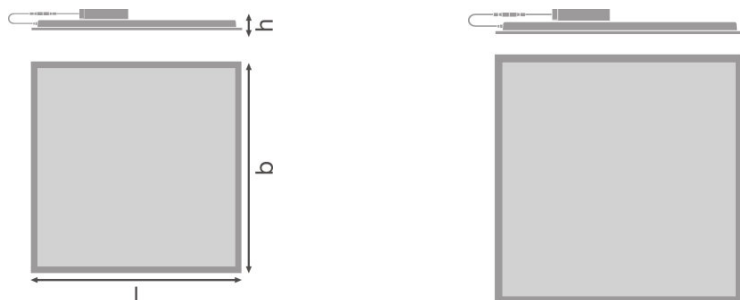

<b>Length</b>	595.0 mm
<b>Width</b>	595.0 mm
<b>Height</b>	35.0 mm
<b>Product weight</b>	1800.00 g
<b>Mounting width</b>	580.0 mm
<b>Mounting length</b>	580.0 mm

## Colors &amp; materials

<b>Product color</b>	White
<b>Housing color</b>	White
<b>Body material</b>	Aluminum
<b>Light emitting surface material</b>	Polystyrene

## Temperatures &amp; operating conditions

<b>Ambient temperature range</b>	-10...+45 °C
----------------------------------	--------------

## Lifespan

<b>Number of switching cycles</b>	25000
<b>Lifespan L70/B50 at 25 °C</b>	50000 h
<b>Lifespan L80/B10 at 25 °C</b>	50000 h
<b>Lifespan L90/B10 at 25 °C</b>	30000 h

## Additional product data

<b>Mounting type</b>	Recessed/Suspended/Surface
<b>Mounting location</b>	Ceiling / Wall
<b>Low flicker</b>	Yes
<b>Product remark</b>	Available from February 2020

## Capabilities

<b>Dimmable</b>	No
<b>Type of connection</b>	Screwless terminal
<b>LED module replaceable</b>	Not replaceable

### Certificates & standards

<b>Type of protection</b>	IP40
<b>Protection class</b>	II
<b>Protection class IK (shock resistance)</b>	IK02
<b>Glow Wire Test according to IEC 60695-2-12</b>	650 °C
<b>Photobiological safety group EN62778</b>	RG 0
<b>Standards</b>	CE/CB/EAC/RoHS

### Light Distribution

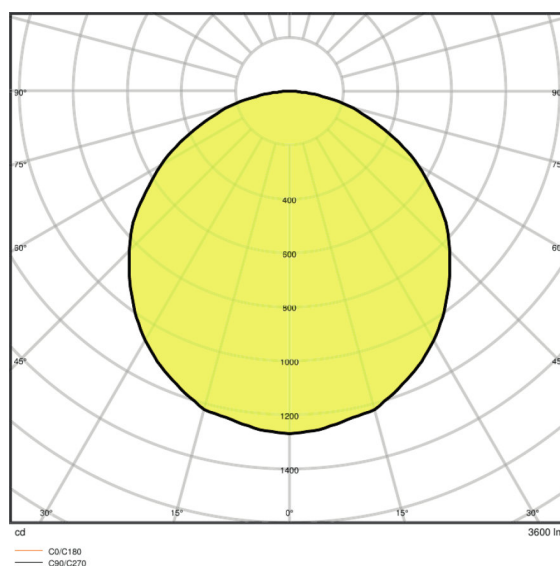

LDC typ cone

LDC typ polar

### EQUIPMENT / ACCESSORIES

- Accessories for several mounting options available
- External control gear included
- Security brackets included

### LOGISTICAL DATA

Product code	Packaging unit (Pieces/Unit)	Dimensions (length x width x height)	Gross weight	Volume
--------------	------------------------------	--------------------------------------	--------------	--------

4058075392366	Folding carton box 1	602 mm x 40 mm x 648 mm	2192.00 g	15.60 dm <sup>3</sup>
4058075392373	Shipping carton box 4	667 mm x 182 mm x 634 mm	10015.00 g	76.96 dm <sup>3</sup>

The mentioned product code describes the smallest quantity unit which can be ordered. One shipping unit can contain one or more single products. When placing an order, for the quantity please enter single or multiples of a shipping unit.

#### ADDITIONAL CATALOG INFORMATION

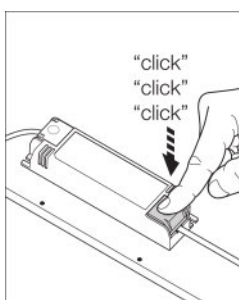
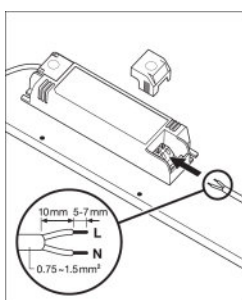

#### REFERENCES / LINKS

For Guarantee see

— [▶ www.ledvance.com/guarantee](http://www.ledvance.com/guarantee)

#### DISCLAIMER

Subject to change without notice. Errors and omission excepted. Always make sure to use the most recent release.