



Emergency Assist Alarm - CFEAPULLKIT

Installation & User Guide

Kit Contents

This kit comprises of everything required for the complete installation of a BS8300 Compliant Emergency Assistance Alarm, (excluding cables and fixings).

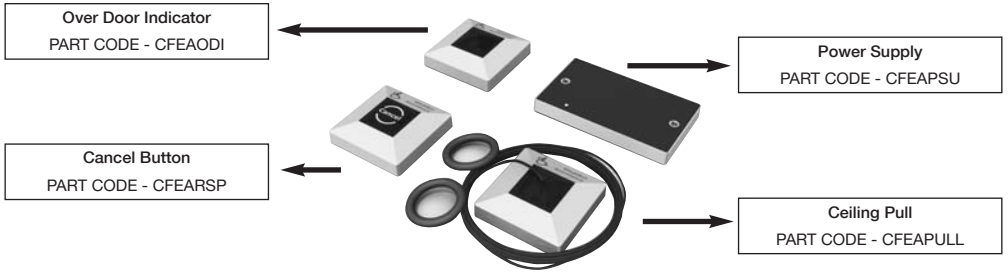

Mains Wiring

The general requirement for the mains supply to the call controller is fixed wiring, using three core cable of not less than 1mm². This should be fed from an isolating switched fused spur, fused at 3A, which is marked appropriately and secure from unauthorised operation.

All mains wiring should be provided in accordance with the current edition of the IEE Wiring Regs (BS 7671) or in accordance with the relevant national wiring rules.

Extra Low Voltage (ELV) Wiring

Always segregate low voltage wiring from the mains wiring.

System requires minimum 2 core 0.4mm² cable.

It should be noted that the wiring order of the various system components can be changed to suit a specific application and/or to reduce wiring runs.

All wall-mounting devices should be mounted onto a back box of the required depth.

Wiring Guide Using 2 Core Cable

OUT	IN
PSU 12V supply	Over Door Indicator
Over Door Indicator	Cancel Unit
Cancel Unit	Pull Cord Unit

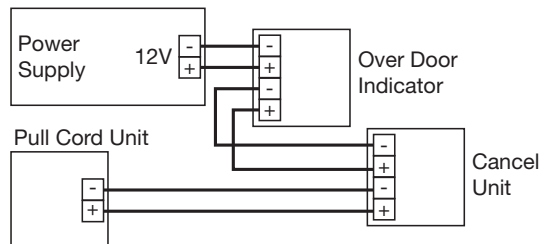

Installation

The Emergency Assist Alarm should be installed in accordance with the recommendations of BS8300 and to the requirements of Building Regulations Approved Document M.

The below diagram demonstrates a typical layout for installation in a disabled person toilet.

Note: Where pertinent other or alternative standards of design and installation should be adhered to.

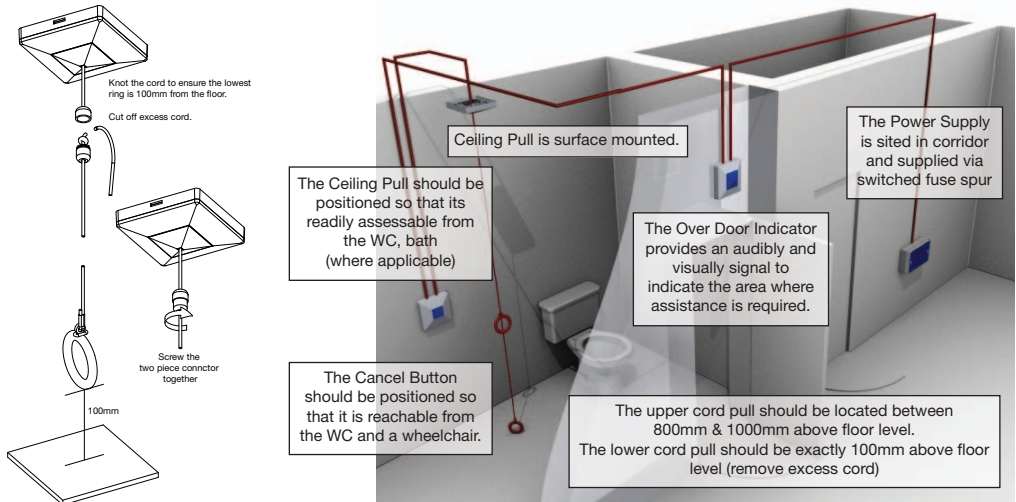

All system components are designed to be sited internally and positioned in locations where they are readily accessible by the user. The area should be clean and dry and sound and light levels allow the status of all device indicators and sounders to be seen and heard.

Any likelihood of tampering or vandalism should also be taken into account at time of design.

Operation

- Normal State** Power Supply Unit power LED is lit.
- To Place a Call** Operate the Pull Cord. LED's will illuminate on, Pull Cord Unit, Cancel Unit and Over Door Indicator. An internal buzzer will also sound in the Over Door Indicator.
- To Reset Call** Press the Cancel Button.

Maintenance

- Weekly** Clean plates with a non abrasive cleaning cloth and detergent, do not use harsh or solvent based cleaners.
- Monthly** Test Call system by making and resetting a call.

Cooper Safety Fire Systems

Cooper Lighting and Safety Ltd
Wheatley Hall Road
Doncaster
South Yorkshire
DN2 4NB
United Kingdom

www.cooperfire.com

Sales

T: +44 (0)1302 303 999
F: +44 (0)1302 303 333
E: sales@cooperfire.com

Technical and Quotations

T: +44 (0)1302 303 350
F: +44 (0)1302 303 332
E: techsupport@cooperfire.com

Service

T: +44 (0)1302 303 352
F: +44 (0)1302 303 332
E: service@cooperfire.com

Export

T: +44 (0)1302 303 344
F: +44 (0)1302 303 345
E: export@cooperfire.com

Trade Descriptions

All descriptions represent only particulars of the goods to which they apply and do not form part of any contract. The company reserves the right to change specification without prior notification or public announcement.

@2011 Cooper Lighting and Safety
All rights reserved.

Publication Reference: PINSTCFEAPULLKIT / PR211-180-518-02



CE



Awarded to:
Cooper Industries (UK) Ltd

COOPER Safety
Fire Systems