

sofamel

Product Technical Specifications

Mod. AFM

Insulated male connector

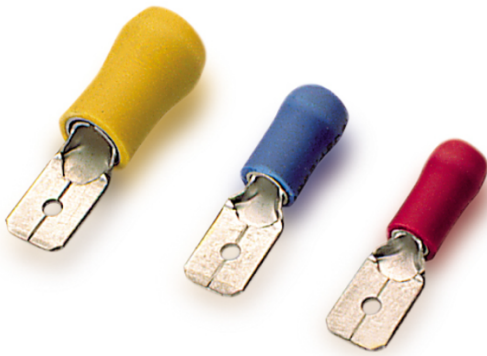

Functionality

These **pre-insulated copper terminals** are used where a plug-in male connection is required. They consist of an insulated tubular inlet for wiring and a plug-in connector.

Product Features

Los terminales preaislados AFM están fabricados con fleje de cobre electrolítico y aislamiento en **PVC**. Incorporan un casquillo interior que confiere una mayor seguridad para soportar posibles vibraciones mecánicas.

La resistencia al calor es de **-10 a 75°C**.

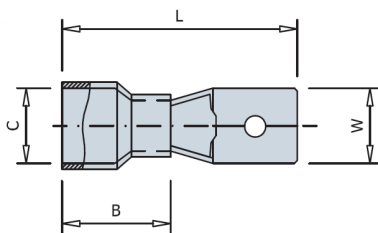

RANGE / DIMENSIONS OF PRODUCT									
Code	Ref.	Section (mm ²)	Dimensions (mm)				Kg x 1.000	Bag	Box
			W	L	B	C			
295100	AFM-1,5	1,5	6,35	21,8	10,5	1,7	0,805	100	1600
295110	AFM-2,5	2,5	6,35	21,8	10,5	2,3	0,929	100	1400
295120	AFM-6,0	6,0	6,35	24,0	13,0	3,4	1,452	100	800



Mod. AFM

Insulated male connector

Raw Material Features

Conductor: **Brass strip H62 / C28000**
Copper sleeve: **Tubular copper T2 / C11000**
Isolation: **PVC**
Finished: **Tinned**

Certified

They comply with Directive **2015/863 / EU** of the European Union (**RoHS 3**).

Quality tests according to **UNE 21021**.

Electrical Features

The maximum intensity will depend on the section of the cable used, if it is ventilated, it will hold more current.

With the AFM terminal:

Section **1.5mm²** and **1.5mm²** cable can hold between **13** and **15.5 A**.

Section **2.5mm²** and **2.5mm²** cable can hold between **18** and **21 A**.

Section **6mm²** and **6mm²** cable can hold between **31** and **36 A**.