

# sofamel

Product Technical Specifications

## Model APF/D

Twin cord end terminal



### Functionality

These pre-insulated copper terminals are used where a connection is required that allows the cable to connect and disconnect quickly from the components, where screws or clamps are used to make electrical contact with the cable.

### Product Features

APF/D hollow toe caps are made of electrolytic copper capillary tube with a tin-plated silver finish to improve electrical contact. The insulating part is made of polypropylene (PP). They are designed for electrical panels.

Insulating material with flame retardant additives.

Operating continuous temperature: 90 °C.



## Model APF/D

### TWIN CORD END TERMINAL

#### Raw Material Features

**Terminal material:** Copper, Nylon.

**Plating:** TIN

**Insulation:** PP, halogen free.

#### Dimensions

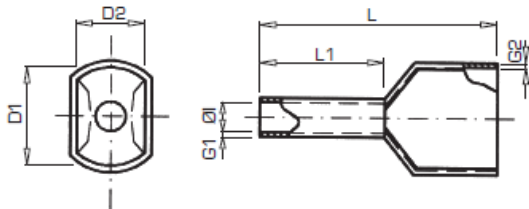

#### Certified

They conform to the provisions established in Directive **D.C 2014/35/UE** on electrical equipment intended for use with certain voltage limits of the Council of the European Communities.

They have been tested according to what is established in the **UNE 21021** standard:

Connecting parts for power lines up to 72.5 kV.

**UNE EN 60998-1: 2005** Connection devices for low voltage circuits for domestic and similar uses. Part 1: General requirements.

**ROHS, UL 786** and **ZMVV8.E483127**: Cable connectors and soldering tips certified for Canada – Components. **CE** Marking

Sección (mm <sup>2</sup> )	Dimensiones (mm)						
	ØI	D2	D1	L	L1	G1	G2
0,50	1,5	2,5	4,7	15,0	8,0	0,15	0,25
0,75	1,8	2,8	5,0	15,0	8,0	0,15	0,25
1	2,3	3,4	5,4	15,0	8,0	0,15	0,30
1,5	2,3	3,6	6,6	16,0	8,0	0,15	0,30
2,5	2,9	4,2	7,8	18,5	10,0	0,20	0,30
4	3,8	4,9	8,8	23,0	12,0	0,20	0,30
6	4,9	6,9	10,0	26,0	14,0	0,20	0,40
10	6,5	7,2	13,0	26,0	14,0	0,20	0,40
16	8,3	9,6	18,4	30,0	14,0	0,30	0,40

Datos sujetos a cambios  
2022, september 12

© 2017 Sofamel SLU  
Todos los derechos reservados.

Versión: R2-7.2 COM01

Las especificaciones están sujetas a cambios sin previo aviso.